

OPERATIONS MANUAL

IM-30 MM



!!! For your safety In order to obtain
higher performance of your equipment !!!
Read the instructions manual carefully

[Http://www.inmes.com.br](http://www.inmes.com.br)



CONGRATULATIONS!

Congratulations for choosing the IM-30 MM and thanks for your confidence in INMES products.

This equipment was developed to satisfy safety and meet your needs for high performance. The IM-30 MM was especially designed to make high-quality cuts in wood, profiles, however each material requires the proper blade.

We developed this Owner's Manual to help you install and use your machine correctly in order to obtain the maximum benefits of economy and output.

Read the manual carefully and call us to answer any question you may have about your equipment and its operation.

Visit our web site:

<http://www.inmes-usa.com>

Visit us and check out our wide range of products.

1 - SAFETY INSTRUCTIONS

For operator safety and durability of your equipment, the instruction must be carried out with great care when installing and operating your machine, staying alert and learn how to use the IM-30 MM.

1.1 - Safety Signals



If the safety instruction is not followed the operator will be seriously injured or killed.



Means if the safety instruction is not followed the operator could be seriously injured or killed.



Safety instruction if not carried out with care, might injury the operator.

1.2 - Before using the machine



- ✓ Read the owner's manual before operating the equipment;
- ✓ Wear safety goggles,
- ✓ Keep the acrylic blade guard down;
- ✓ Keep hands out of the saw blade path;
- ✓ Turn off and wait for blade to stop, before adjusting;
- ✓ Before plugging in the machine to the electrical INMES Industrial recommends to use a thermo magnetic circuit breaker on the electrical source as instructed in item 5.3 described in this instructions manual;
- ✓ The manufacturer advice: you should make sure the circuit is properly grounded, using the green and yellow wire for this purpose;
- ✓ The machine must be mounted on a flat surface in an appropriate work area, well lighted and enough air;
- ✓ This machine only accept blade of 300mm
- ✓ In order to obtain high performance at work, make sure that you read the owner's manual.

1.3 - Blade Requirement

The saw blade must proceed the following specifications:

- Extern diameter => 300 mm;
- Arbor diameter => 30 mm;
- Blades marked for 4 000 rpm or higher;
- Blades must be appropriated for each specific material (wood or plastic);



- ✓ Do not use high speed steel sawblade because our sawblades work at a 1200rpm.

1.4 - When Installing the equipment

- The machine must be mounted on a flat surface in an appropriate work area, well lighted and enough air;
- Before switching on the machine, verify the frequency and voltage;
- The electrical installation should be made by an electrician, as well as questions or problems you may have with your electric installation should be resolved by an electrician;
- Make sure you are using the correct voltage.

1.5 - Before Each Use

- Make sure switch is in OFF position before plugging in
- Make sure before operating that all parts and connections are tight;
- Keep the machine free from cutting residuals;
- Remove any existent foreign objects or tool between the fence and clamping;
- Verify blade spreader before start again;
- Always use the acrylic blade guard assembled;

1.6 - To reduce the risk of injury

CAUTION

- When cutting the profiles, the rabbet must be facing the operator, as shown in figure 01 (F). Must be avoid cuts as figure 01 (C) or else the saw blade can pull the scrap piece into the machine, and that way offering risk to the operator or damage to the machine.
- In order to obtain a good finishing and safety when cutting observe on top of the profile that you must allow at least 3/8" (10mm) of wood between the cut and the end of the stick as figure 01 (B).

- Never place your hand near the blade;
- Hold the profile firmly to the fence;
- Be careful when cutting small pieces, the profile or small scrap may move and break the blade or even damage other parts;
- When cutting long profiles, its necessary to use extension table (have our authorized distributor called), this accessory will let the profile lay flat on the extension during cutting operation;
- Let the blade get full speed before cutting;
- Do not use blades which are not in a good shape, for instance, broken teeth, because they are out of balance and will not make good cuts, as well as creating a hazard for the operator;
- Before starting the machine make sure that no objects have been left on the base;
- Soldered and unbalance blade must not be used;
- If any part is missing, bent or broken in any way, or electrical part does not work properly, turn the saw off, unplug the saw and provide the proper maintenance;
- Never use your machine if you observe something which can cause an accident or damage the machine;
- Use only sharp blade;

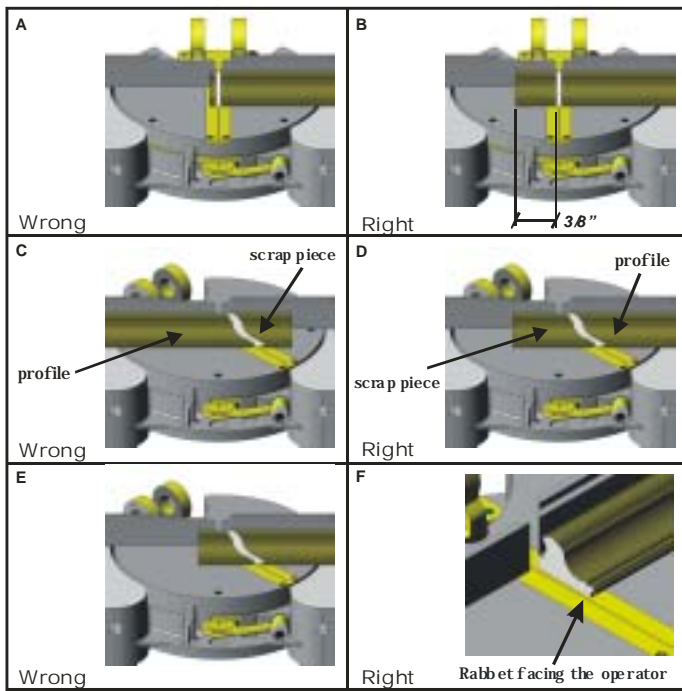

Figure 01

- Keep the saw blade clean;
- Keep work area around clean, sawdust can make the floor slippery;
- Make sure there is no debris between the work piece and the fence;
- Never cut more than one work piece at a time;
- Anytime the saw blade is removed for replacement or maintenance; make sure that the machine is unplugged from the wall socket;
- After replacing make sure the blade is properly tight;
- Keep visitors and children away when using;

Note: Always remember that careless fraction of a second is enough to cause a severe injury

1.7 - Plan your cut

Tip:

- ✓ When you have a large quantity of profiles to be cut, and you want to do this in a quick way, we advice the operator to cut first one side, and then the other side. It means rapidity and will save your time, for it's not necessary to move the blade position several times.

- Make sure the machine has enough cutting capacity to cut the profile you wish to;
- Use appropriate blade for cutting, depending on the type of material to be cut (wood or plastic);
- When cutting the profiles with rabet, the rabet must be facing the operator as figure 01 (F).

1.8 - Protection:

- Do not wear loose clothing, gloves or jewelry, neckties. They can caught you and draw you against the moving parts;
- Tie back long hair;
- Wear ear plugs or muffs;
- Always wear safety goggles;
- For dusty operations, wear a dust mask along with safety goggles;
- Always remember that a fraction of a second can cause a serious injury.

WARNING



Keep hands and fingers away from saw blade.

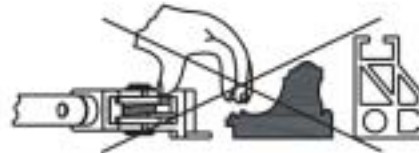

Do not place your hands between the hold-downs and the fence.

Before leaving the machine

- Turn the saw off and wait for all moving parts stop;
- Unplug the saw;
- Disconnect the circuit breaker from the power.

2 - UNPACKING AND CHECKING CONTENTS

As soon as you receive the IM-30 MM Rotating Miter Saw, make sure that all parts are included. The following parts are included:

Part or Assembly	Quantity
Basic IM-30 MM Rotating Miter Saw	01
Mechanical Clamping System	01
Right Table Extension	01
Left Table Extension	01
Moulding Stop	01
Combination Wrench 24 x 27 mm	01
Phillips 3/16" x 4"	01
Wrench (for motor flange)	01
Allen 6mm	01
Warranty	01
INMES Repair Center	01
Owner's Manual	01

WARNING

- ✓ If you are missing any part, do not assembly the saw, contact our authorized distributor.

DANGER

- ✓ Do not plug the power cord into a power source outlet when unpacking and assembling.

CAUTION

- ✓ To avoid back injury get help whenever you have to lift the saw.
- ✓ Inmes developed a movable base for IM-30; contact our distributor for further information.
- ✓ Place the saw on a secure work surface.

Important:

- ✓ Before installing the machine, make sure that you have all the parts included.
- ✓ If you are missing any part, please do not hesitate to contact our distributor.
- ✓ Always order by part number, use "Vista explodida" you may find it at the list of parts located in the end of the manual.
- ✓ This manual is extremely useful when ordering spare parts, therefore keep it in a appropriate place, should you have more than one equipment the same model, identify the equipment writing the serial number on its manual.

Optional Accessories:

- ◆ Additional Right Table Extension
- ◆ Additional Left Table Extension
- ◆ 90° moulding stop or 45° moulding stop
- ◆ Work Stand
- ◆ Additional accessory for Fence

3 - GETTING TO KNOW YOUR MITER SAW

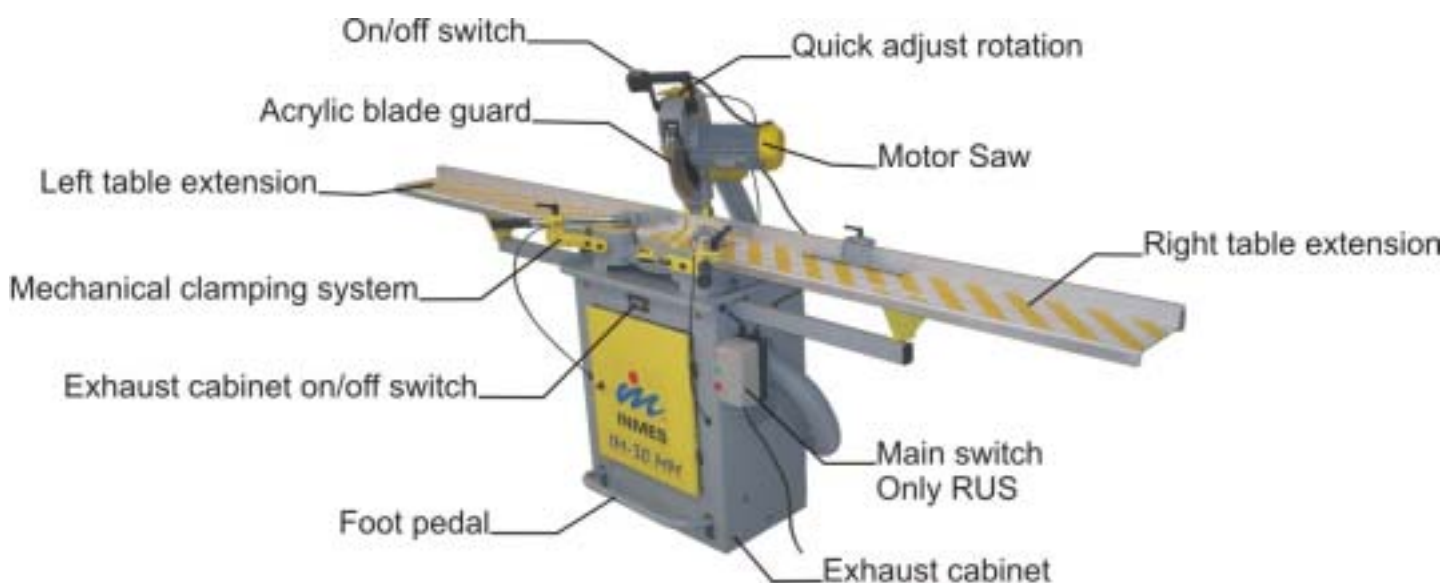

4 - INSTALLING THE EXHAUST CABINET



Figura 02

(Russia model)

1° - Attach the main switch 05 to the cabinet base 06 using the washers 07 and bolt 08 as shown in fig. 02.

2^a - Turn the main switch 05 fig.02.

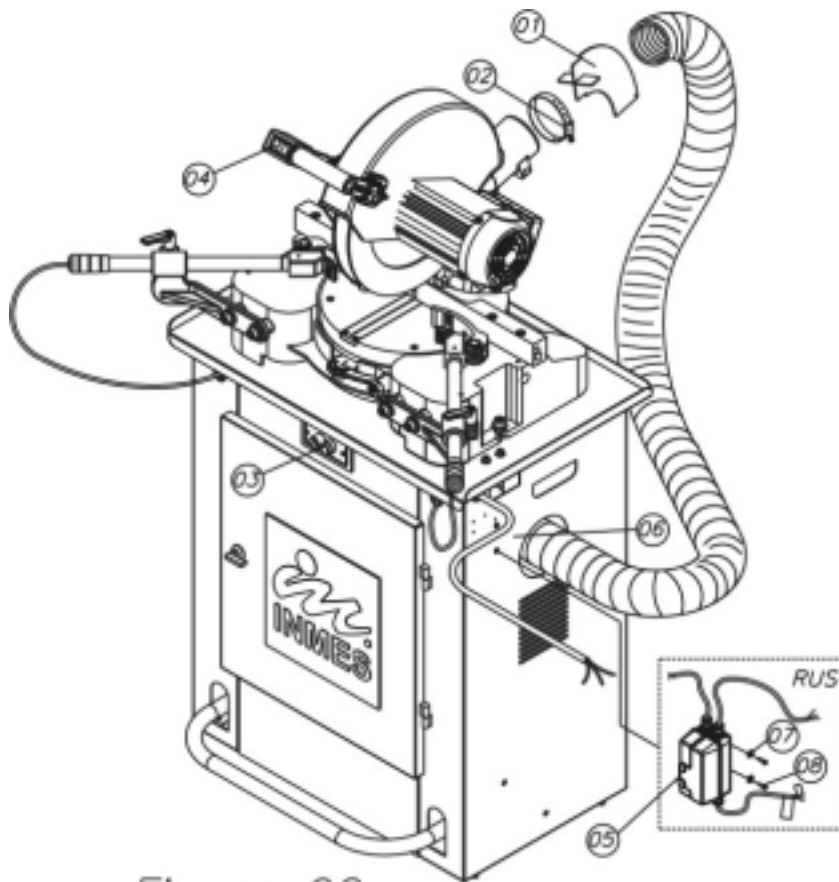
3^a - Turn on the dust collector 03 fig. 02.

4^a - Turn on the saw 04 fig. 02.

1^a - Turn off the saw 04 fig. 02.

2^a - Turn off the dust collector 03 fig. 02.

3^a - Turn off the main switch 05 fig. 02.

To install the exhaust cabinet you must fit the part (01) into the hose and then attach this end of the hose over the aluminum saw casting outlet using a clamp 02 to tighten it. Once this procedure is done attach the other side of the hose over the dust collector located inside the cabinet using a clamp to tighten the hose.

As the saw dust is collected in a cloth bag located inside the cabinet, we do recommend to empty the bag at least twice a week in order maintain the high performance of your equipment.

In order to turn the dust collector on and off you must press the switch 03 and then turn on the saw by pushing the switch 04 fig. 02.

5 - IM-30 MM ELECTRICAL INSTALLATION



- ✓ Read the manual and the safety instruction carefully before connecting the plug to the power source.
- ✓ Make sure that all the screws are tight before installing the machine.

- ✓ To reduce electrical shocks or damage to the machine, unplug it from the power source before any maintenance;
- ✓ If power cord is worn, cut or damage in any way, you must replace it right way;
- ✓ The electrical service must be performed by an specialist;
- ✓ Always install the machine in a dry floor, never expose the equipment in rain;
- ✓ Never place your hand or finger on the terminals of plug when installing or removing the plug to or from the outlet;
- ✓ Overloading can occur if the operator start and stop many times in a short time, also the use of improper or dull saw blades are used;
- ✓ Before plugging in the machine to the electrical INMES Industrial recommends to use a thermo magnetic circuit breaker on the electrical source as instructed in item 5.3 described in this instructions manual.

When using the machine for the first time, the operator must check out if the direction rotation of the motor is right, otherwise he (she) must invert it.

- To invert the direction rotation in three phased machines, its necessary the inversion the two of the three wire from power source, changing one for another. This proceed must be done by a specialist.
- To invert the direction rotation in single phased machines, you must change the wires position 5 and 8 (change one for another), inside the connection box. This proceed must be done by a specialist.

5.1 - Motor specifications for IM-30 MM

Induction motor three phase or single phase.

Available in:	Consumed Power kw/h:	Amps:
115 V Single Phase	1,27 kw/h	11,00 A
208-230 Single Phase	1,22 kw/h	5,55 A

Rotation	3400rpm
Power	1 hp
Frequency	60Hz 50Hz

Bearing	
Front	6204 DDU ARZ S1
Back	6201 ZZ ARZ S1

5.2 - Motor Specification for Exhaust Cabinet

Motor Induction three phase or single phase.

Available in:	Consumed Power kw/h: 50Hz - 60Hz	Amps: 50Hz - 60Hz
115 V Single phase	1,20 kw/h	10,40 A
208-230V Single Phase	0,80kw/h - 1,12 kw/h	3,64 A - 5,10 A
Rotation:	3535 rpm	
Power:	0,75 hp	
Frequency:	60Hz	
	50Hz	

5.3 - Chart with specification for thermo magnetic circuit breaker

Inmes Industrial recommends installing a thermo magnetic circuit breaker on the electrical source, preferably IEC Curve C standard (For inductive equipments) before connecting the machine to the electrical source and make sure the circuit is properly grounded using the green/yellow wires for this purpose. This service must be performed by a qualified staff.

In order to select an appropriate circuit breaker for your equipment use the chart below:

Tension	Frequency	Nominal current for motor	Recommended circuit breaker
110V Single phase	60Hz	11A	Bipolar 16A
220V Single phase	60Hz	5,55A	Bipolar 10A

For the cabinet base with dust collector motor is also recommended to use a thermo magnetic circuit breaker on the electrical source, preferably IEC Curve C standard (For inductive equipments) before connecting the machine to the electrical source and make sure the circuit is properly grounded using the green/yellow for this purpose. This service must be performed by a qualified staff.

In order to select an appropriate circuit breaker for the cabinet base use the chart below:

Tension	Frequency	Nominal current for motor	Recommended circuit breaker
110V Single phase	60Hz	10,4A	Bipolar 16A
220V Single phase	60Hz	5,1A	Bipolar 10A

6 - INSTALLING AND MANTAINING THE SAW BLADE

WARNING

- ✓ Use only blades of 300mm diameter.

Important

Each material that you wish to cut (wood, plastic or aluminum) requires a specific saw blade.

DANGER

- ✓ The manufacturer advice do not use either cracked or welded saw blade.
- ✓ Make sure all safety protection are correctly installed.
- ✓ After changing or maintaining the blade, make sure it is well tightened before starting the machine.

DANGER

- ✓ Do not use high speed steel sawblade because our sawblades work at a 1200rpm.

Tools needed:

- 01- 24x27 wrench (supplied with machine)
- 02- 27 wrench (supplied with machine)
- 03- 3/16"x4" Phillips (supplied with machine)

You must follow the following steps:

Wear leather gloves when replacing or maintaining the blade.

Remember: Whenever the operator remove the blade for replacement or sharpening, its extremely important to unplug the power cord from power source.

Once this is done proceed as shown as figure 03, following these steps:

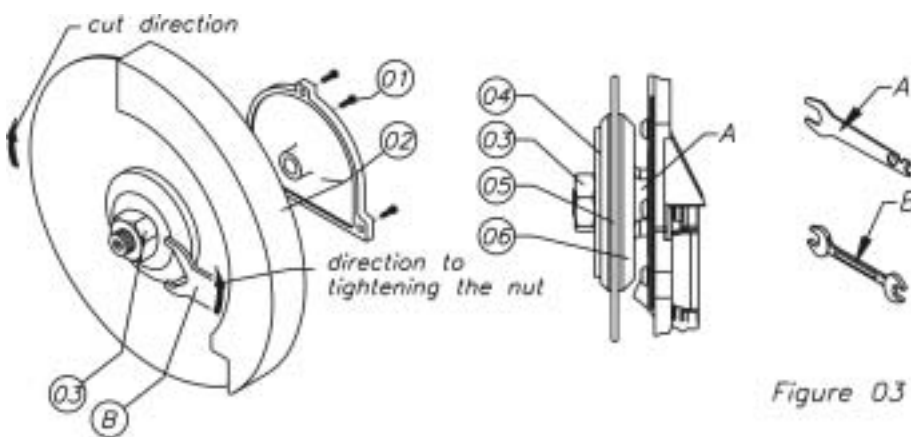

- 1) Remove the three bolts from the yellow plastic flange, figure 03 (01);
- 2) Remove the yellow plastic flange and the acrylic blade guard figure 03 (02);
- 3) Insert wrench 1 in the region A as shown in figure 03 (06);
- 4) Then Using wrench B turn the blade nut

clockwise, loosen the nut, as shown figure 03 (03);

- 5) Rotate the wrench B down;
- 6) Rotate the wrench A up;
- 7) Remove the nut figure 03 (03);
- 8) Take the flange off figure 03 (04);
- 9) You are finally ready to remove the blade, figure 03 (05);

To replace the blade you must follow these steps:

When installing a blade, make sure the blade is clean and free of any protective coating;

When replacing the blade pay attention to the direction of the blade's teeth.

Once you have checked all these points, then you will be able to replace the blade, following the respecting steps:

- 1) Blade;
- 2) Flange, figure 03 (04);
- 3) Nut, figure 03 (04) manually tight to the end;
- 4) Insert wrench A in the region A, figure 03 (06);
- 5) Then using wrench B turn the blades nut counter clockwise, figure 03 (03);
- 6) Make sure the blade is well tight;
- 7) Fit the acrylic blade guard item 02, around the blade and right after that fix the yellow plastic flange with three screws by a Phillips key;
- 8) Make sure the flanges are clean and properly arranged;
- 9) Lower the blade into the table slot and verify for any contact with the base;
- 10) If the blade contacts table, verify all the procedure that you have done, if you still have problem to adjust your machine contact authorized service.

7. MOUNTING THE IM-30 SPRING

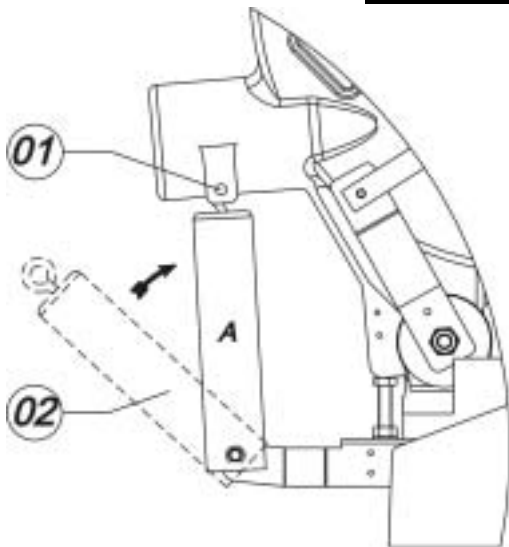

Figure 04

Before beginning working with your IM-30 Plus Rotating Miter Saw, its necessary to install the spring, which it is already pre-assembled on the machine.

To mount the spring, remove the bolt fig. 04 (01) using Allen key 6mm that comes with the machine. Lift the top as far as possible, using the handle, place the spring in the direction of the arrow, until you are able to replace bolt in its original hole.

8. OPERATING YOUR IM-30 MM ROTATING MITER SAW

CAUTION

- ✓ Use only saw blades specifically recommended for wood, plastic, or aluminum, according to the material you want to cut.

WARNING

- ✓ As soon as you have done, turn off the saw and unplug the cord power from the out let.

8.1 - Cutting Capacity

This machine has been designed for cutting profiles related in the following drawing below, according to the respective cutting angles.

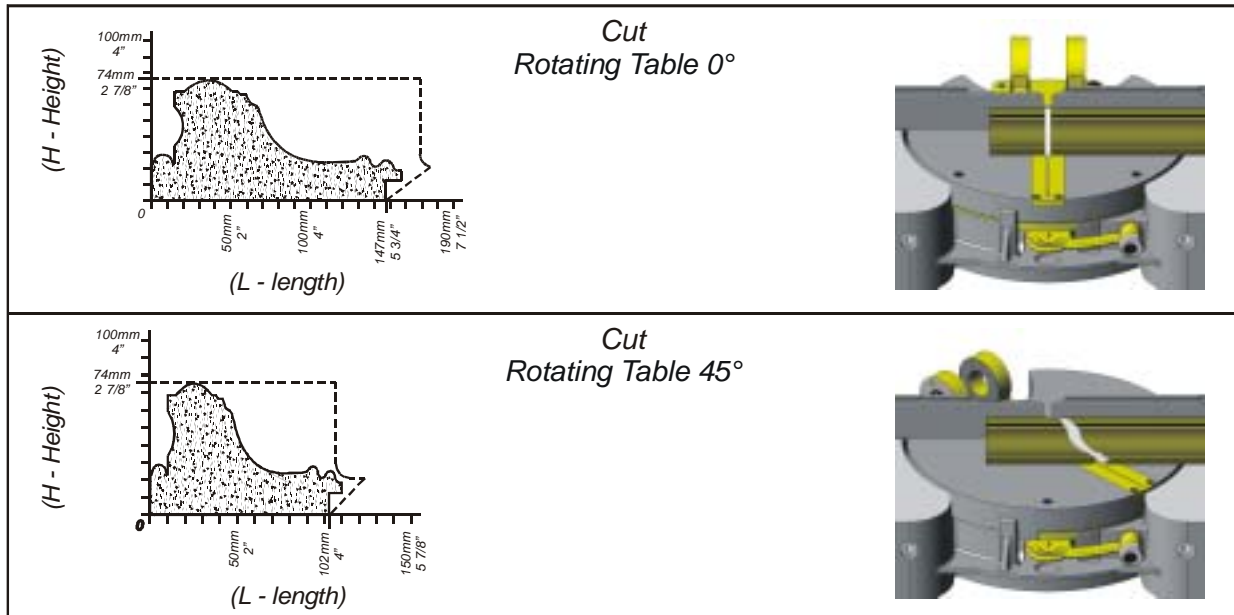

8.2 - Choosing the right angle you wish to cut

The IM-30 MM has a quick adjust rotation feature with precision lock position for the most used angles (45° - 30° - 22,5° - 15° - 10°), and respectively for square and rectangles 6-8-12 and 18 sided frames, and manual adjust for the other angles.

There are two ways you can adjust the cutting angle.

First:

The operator may use the "quick adjust rotation" feature, which is operated by squeezing the part that looks like a bicycle brake in the middle the saw handle (next to the On/Off switch) in order to rotate the table. When the desired angle of position has been reached, just released it to engage again.

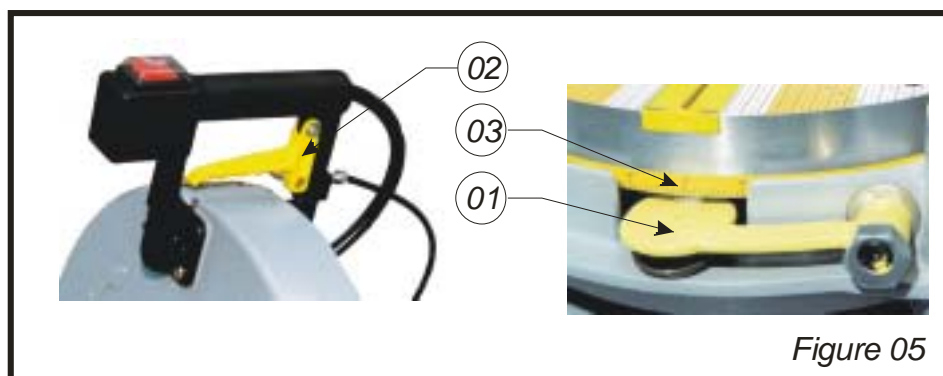

Second:

The operator may press down on the yellow lock disc on the front of the machine to disengage it, then rotate the saw table until it reaches the position desired, then engage the lock again by releasing the disk, taking care to have the position properly aligned, so as not to damage the lock pin.

It is possible to obtain the manual adjustment, as before press down on the yellow disk to disengage the lock, rotate the saw to the angle desired, and then release the yellow disk, then tighten the screw on top of the fence with your 5mm Allen wrench, which locks the rotating table in place.

Depending on type of frame to be made, follow the table below:

<i>Sides</i>	<i>Angle</i>
<i>04</i>	<i>45°</i>
<i>06</i>	<i>30°</i>
<i>08</i>	<i>22,50°</i>
<i>12</i>	<i>15°</i>
<i>18</i>	<i>10°</i>

8.3 - Operating mechanical clamping system

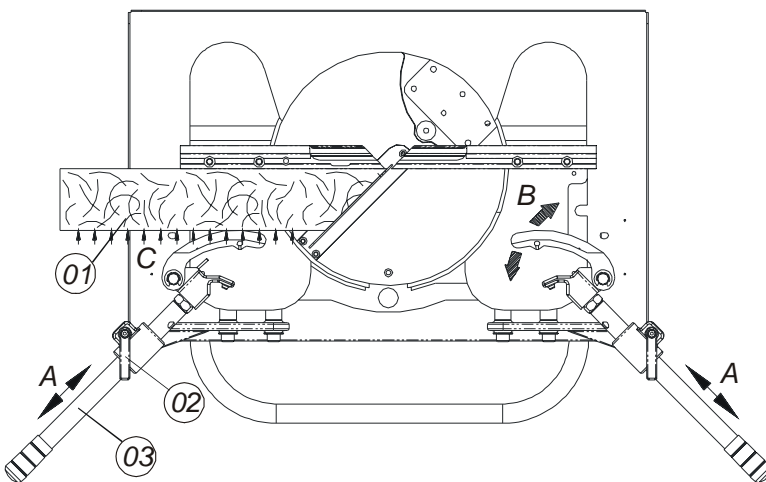

1. Choose the profile you wish to cut (01);
2. Release the handle (02);
3. Step on the foot pedal (05) all the way down, and keep it pressed;
4. Adjust the clamping system (03) in the way of the arrow "A" in order to fit the profile;
5. Place the profile between the fence and the clamping;
6. Tight the handle (02);
7. Release the foot pedal (05);
8. Make sure to obtain a space of about 3/8" (10mm) between the clamping and the profile before releasing the foot pedal;

9. Observe that when stepping on the foot pedal (05) the clamping (04) moves in the way of arrow "B" and "C";
10. The clamping clamps the profiles in the way of arrow "D"



- ✓ Before cutting, observe the clamping (04) fig (06); if it's clamping the profile in the correct way, otherwise it's possibly to release during cutting, damaging the machine, or even hurting the operator.

9 - MAINTENANCE

WARNING

- ✓ For operator safety always turn the saw off and remove the plug from the power source outlet before cleaning or lubricating your equipment. If these instructions are not followed the operator may be injured.

Important

- ✓ To avoid damage to your equipment, use only original parts.

9.1 - Alignment

To check the blades' alignment, its required 24 x 27 mm wrench, combination square, 6mm Allen wrench.

Correction of the cutting angle

In case the angles are not true, you may start with the saw blade in the 0° position, to adjust the calibration you must use a precision square to guarantee a perfect alignment of the blade. When you have this tool (precision square) in hand, lower the blade, and place the back of the square placed against the fence fig. (09), and the side of the square next to the blade.

After doing this operation, in case the angles are not true, you will notice a very small slot between the square and the blade.

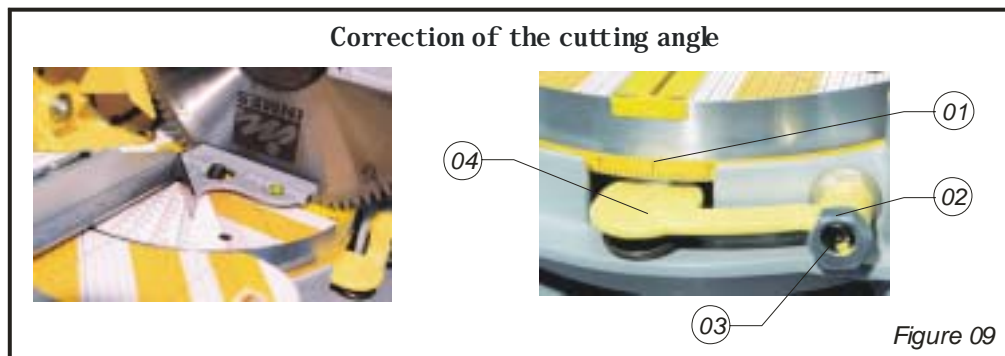

Then use your 06mm Allen, loosen the screw figure 09 (03) then use your 24mm wrench and slowly turn the adjustment screw fig 09 (02) to the left or right, until adjust the angle 90° between the saw blade and the fence of the machine.

After adjusting the angle between the blade and the fence, you must tight the screw again, figure 09 (03), using your Allen 06mm, holding the adjustable screw, figure 09 (02), with your 24mm wrench, make sure the adjustable screw do not move when tightening.

In order to have a perfect adjustment, you may cut 04 pieces and then make the joining.

9.2 Lubrication

- ✓ All the motor bearing in this equipment are lubricated with enough amount of high grade lubricant for the life of the unit under normal operation conditions, therefore, no further lubrication is required;
- ✓ To each eighty (80 hours) working hours it's necessary to lubricate the yellow quick-adjust cable with dust-graphite;
- ✓ It's not required any other type of lubrication for the life of your IM-30 Plus.

10 - TROUBLESHOOTING



- ✓ For your own protection, always switch “Off” and remove plug from power source outlet before troubleshooting.

Problem	Probable cause	Suggested Solution
Motor does not work	Main feed cable not connected	Connect the main feed cable
	Circuit breaker off	Have circuit breaker checked
	ON/OFF switch button damaged	Get authorized service
	Defective contactor (three phase)	Get authorized service
	Motor burned	Get authorized service
Motor rotate to the wrong side	Electric installation	Invert the direction of the motor rotation
Motor does not work fine during cutting	Saw blade not sharpen	Have it sharpen
	Excessive cutting speed	Lower cutting speed
	Model of the saw blade	Use blades with less teeth Use anti-kickback blade
Frequent disconnection of the circuit breaker	Motor over-loaded	Descent the blade slowly Have the motor bearing checked
	Undersized circuit breaker	Install a circuit breaker with proper amp.
High level of noise	Motor bearing damage	Get authorized service
	Motor problem	Get authorized service
Rough cuts	Saw blade not sharpen	Have it sharpen
	Awkward blade	Replace the blade
	Blade incorrectly mounted	Mount the blade correctly
	Blade missing teeth	Replace the blade
	Motor bearing damage	Get authorized service
	Excessive cutting speed	Lower cutting speed
Angle of cut not accurate	Moulding fence misalignment	Get authorized service
	Saw blade misalignment	Make the alignment
	Awkward profile	Try another cut with a straight profile
	Profile moves during cutting	Secure the profile in place before cutting
	Saw blade not sharpen	Have it sharpen
	Debris between the profile and moulding fence	Clean it up
Hard to pull Back	Mains spring is broken	Replace the spring
	Hex nut from pivot shaft is too tight	Release the nut slowly

11 - PART LIST FOR IM-30 MM ROTATING MITER SAW

<i>CODE</i>	<i>DESCRIPTION</i>	<i>CODE</i>	<i>DESCRIPTION</i>
0302022	Saw blade shaft nut	0408025	Allen screw m8x16mm
0306003	Internal flange IM-30	0408026	Allen screw m8x20mm
0306004	External flange IM-30	0408027	Allen screw m8x25mm
0306006	Saw assembly support hing	0408029	Allen screw m8x35mm
0306007	Saw assembly shaft	0408066	Hex nut m5
0306008	Table lock screw nylon tip	0408081	3/16" washer
0306012	Insert for 45° table position	0408091	Allen screw m5x16mm
0306015	Quick-turn handle	0408132	Grease Jet M6
0306016	Table lock screw	0408143	Allen screw m5x10mm
0306018	Rotating table IM-30	0408164	Phillips screw MQP 4x08mm
0306022	Lever pin	0408166	Phillips screw MQP 5x16mm
0306023	Acrylic blade guard lever	0408173	Self-locking nut
0306029	Rotating table lock shape	0408177	Hex nut
0306033	Teflon disk	0408178	Hex bolt
0306034	Support for acrylic blade guar mechanism	0408179	Hex nut
0306035	Blade guar mechanism sheath	0408181	Rotating table cable screw
0306037	Quick turn handle pin	0408183	Rotating table cable
0306039	Cable regulator screw	0408184	Phillips screw MQP 5x16mm
0306053	Acrylic blade guard support	0408191	Phillips screw MQP 4x12mm
0306056	Electric cable-main feed/single phase 1cv	0408200	Washer
0306065	Electric cable main feed / three phase 1cv (2)	0408211	Main saw spring shaft
0306102	Rotating table lock pin	0408212	Self-locking nut
0306104	Electric cable-main feed / three phase 1cv (2)	0408218	3/16" washer
0306105	Electric cable-mail feed / single phase 1cv (2)	0408228	Phillips screw m5x10mm
0306119	Blade guard mechanism bushing	0412024	Plastic wire clamp
0306198	Spring protector	0412182	Capacitor
0306200	Main saw spring support	0412282	Capacitor 240V 50 Hz
0306203	Main saw spring support	0412194	Nylon clamps
0306205	Main saw spring pin	0412224	Switch
0306226	Guide for the cable	0412304	Prensa Cabo PG 11 POL
0302273	Aluminium saw casing	0413053	MOT 1HP 104-120/208-240V 60Hz
0306274	Aluminum base	0413054	MOT 1HP 220-380V 60Hz
0306383	Sheathing IM-30	0413055	MOT 1HP 110/208-240V 50Hz
0306415	Self-locking nut	0413056	MOT 1HP 220-240/380-415V 50Hz
0306464	Motor Helix IM-30	0416017	Rotating table lock spring
0306465	Fan cover IM-30	0416018	Acrylic blade guard mechanism spring
0404005	Bearing 6204 DDU ARZ S1	0416038	Spring
0404039	Bearing 6201 ZZ ARZ S1	0417008	Flexible pin 04x24mm
0405010	Label 220V 60Hz	0417025	Flexible pin 02.5x20mm
0405012	Label 220V 60Hz	0417026	Lock-washer
0405013	Label 380V 60Hz	0417027	Lock-washer
0405014	Label 220V 50Hz	0417030	Key
0405016	Label 220V 50Hz	0417031	Saw assembly support hin guide pin
0405017	Label 380V 50Hz	0419056	Rotating table base scale
0405049	Label	0419080	Right calibrated scale sticker IM-30
0405051	Label	0419081	Left calibrated scale sticker IM-30
0405055	Label 110V 60Hz	0419084	Calibrated scale sticker rotating table IM-30
0405066	Label	P0306024	Rotating table lock

0405084	Label	P0306030	Saw handle
0405088	Label 115V 60HZ	P0306031	Plastic flange
0405089	Label 208-230V 60Hz	P0306032	Blade Insert
0405107	Label 208-230V 50Hz	P0306051	Acrylic Blade Guard
0405108	Label 380-415V 50Hz	P0306019	Connection box
0405192	Label 110V 50Hz	P0306099	Right moulding fence
0405117	Label 240V 50 Hz	P0306100	Left moulding fence
0408015	Allen screw m5x25mm	P0306102	Rotating Table lock Pin
0408016	Allen screw m6x16mm	P0408170	Haste M6x209mm Im-30 (M)
0408019	Allen screw m6x25mm	P0412224	Switch 30223 M2FT2EE3G 15A
0408030	Allen screw m8x40mm	P0416030	Spring
0408033	Allen screw m8x60mm		

12 - PART LIST FOR EXHAUST CABINET

CODE	DESCRIPTION	CODE	DESCRIPTION
0302066	Washer	0408019	Allen screw m6x25mm
0302071	Reduction flange	0408026	Allen screw m8x20mm
0302082	Washer	0408038	Allen screw m10x30mm
0302282	Body of exhaust EM-075	0408069	Hex nut m10mm
0306215	Curve	0408100	Hose clamp
0302294	Rotor EM-075 single phase	0408101	Hose clamp
0302295	Rotor EM-075 three phase	0408108	Hex bolt
0302297	Cover EM-075A	0408119	Hex bolt
0302299	Flange of the cover 075cv (complete)	0408144	Rivet
0302338	Screen protection EM-100A/B EM-075 Z	0408157	Screw 4,2x25mm DIN 7971
0306081	Exhaust support	0408177	Hex nut 6 mm
0306082	Door	0408179	Hex nut 8 mm
0306083	Cabinet	0408191	Phillips MQP
0306120	Filter IM-30	0408200	Washer
0306155	On/Off switch electric cable	0408201	Washer
0306156	On/Off switch electric cable	0408209	Allen screw m4x08mm
0306157	On/Off switch electric cable	0408218	Washer
0306158	Electric cable - main feed	0408219	Washer
0306391	Motor support cabinet base IM-30	0408260	Allen screw m6x20mm
0306429	Electric cable	0407020	Hose PVC 3"
0306430	Electric cable	0412024	Plastic wire clamp
0306431	Electric cable	0412025	Nylon wire support clamp
0306434	Main switch support	0412047	Press for cable ½ POL
0405056	Label	0412051	Rubber gasket
0405066	Label	0412211	On/Off assembly frame
0405074	Label	0412212	On/Off switch
0405088	Label 115V 60HZ	0412398	Main Switch
0405107	Label 208-230V 50HZ	0413020	Motor 115/208-230V 60Hz
0405117	Label 240V 50HZ	0413073	Motor 208/230V 50Hz
0405119	Label	0413105	Motor 240V 50Hz
0408008	Label	0415006	Cabinet door handle
0408018	Allen screw m6x20mm	0415007	Cabinet door hinge
0405120	Label	0417017	Cabinet door gasket

13 - PART LIST FOR MECHANICAL CLAMPING

<i>CODE</i>	<i>DESCRIPTION</i>	<i>CODE</i>	<i>DESCRIPTION</i>
0306085	Foot pedal im-30 (z)	0306401	Pin
0306091	Cable shaft	0306403	Hook m5 for the mechanical clamping (z)
0306092	Foot pedal shaft	0408042	Allen screw m10x50 din 912
0306093	Tube for the foot pedal shaft	0408066	Nut m5
0306107	Adjustment clamping im-30	0408089	Allen screw m6x10 din 912
0306109	Spacer for the mechanical clamping	0408182	Sheating
0306110	Left support im-30	0408192	Break cable 1.75m
0306111	Base for the clamping	0408200	Washer 1/4"
0306112	Left clamping	0408219	Washer 3/8"
0306114	Pin for the clamping	0408254	Pin 1,75mm
0306115	Right clamping	0415011	Gasket for the clamping
0306116	Right support	0416024	Spring
0306117	Handle m8x27mm (mechanical clamping)	0417008	Flexible pin 04x24
0306316	Whasher	0417040	Flexible lock 503.120

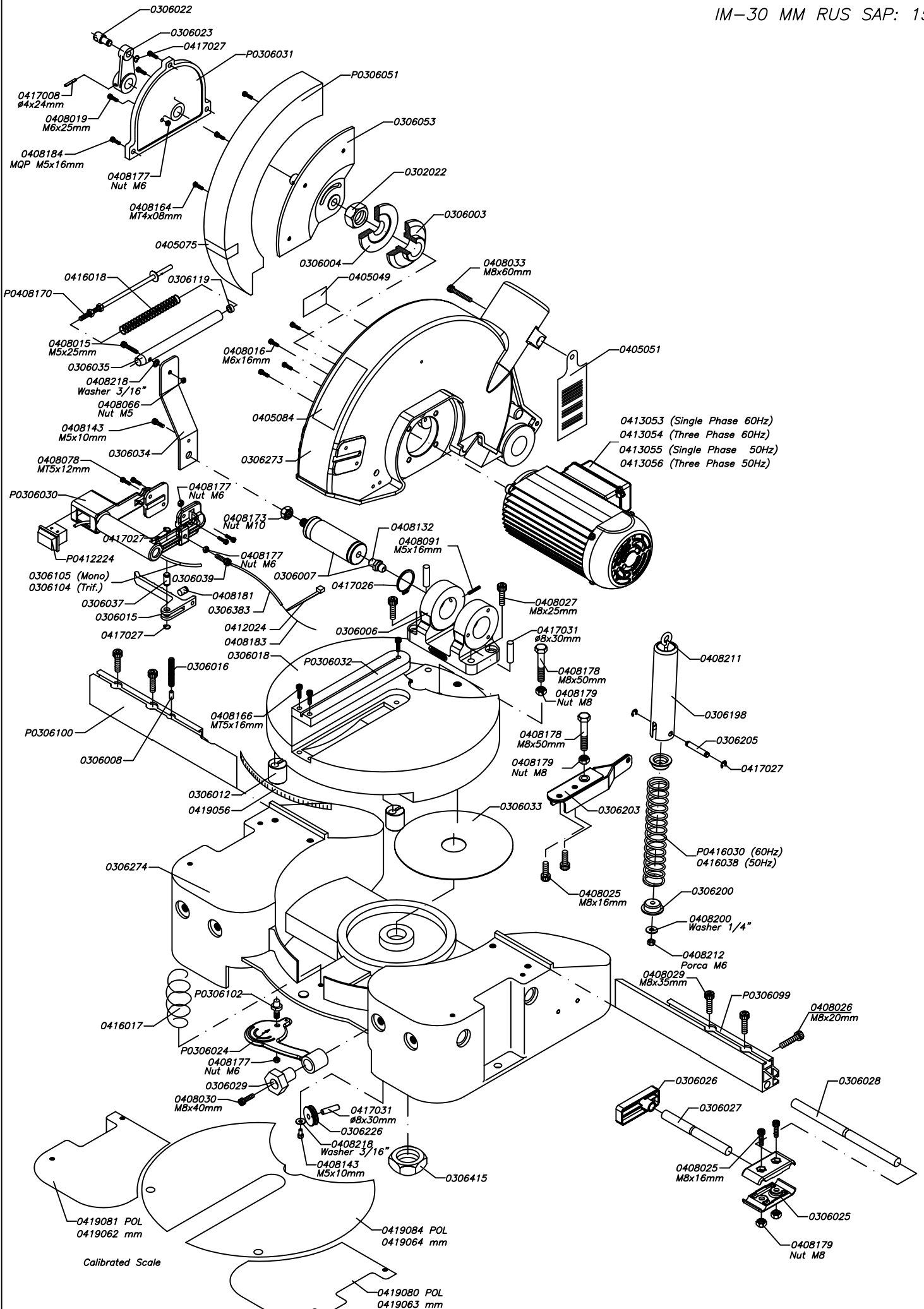

IM-30 MM SAP: 147

IM-30 MM RUS SAP: 153

Motor Single Phase (0413053 60Hz)
(0413055 50Hz)

- 0405192 (110V 50Hz)
- 0405055 (110V 60Hz)
- 0405088 (115V 60Hz)
- 0405107 (208-230V 50Hz)
- 0405089 (208-230V 60Hz)
- 0405014 (220V 50Hz)
- 0405010 (220V 60Hz)
- 0405117 (240V 50Hz)

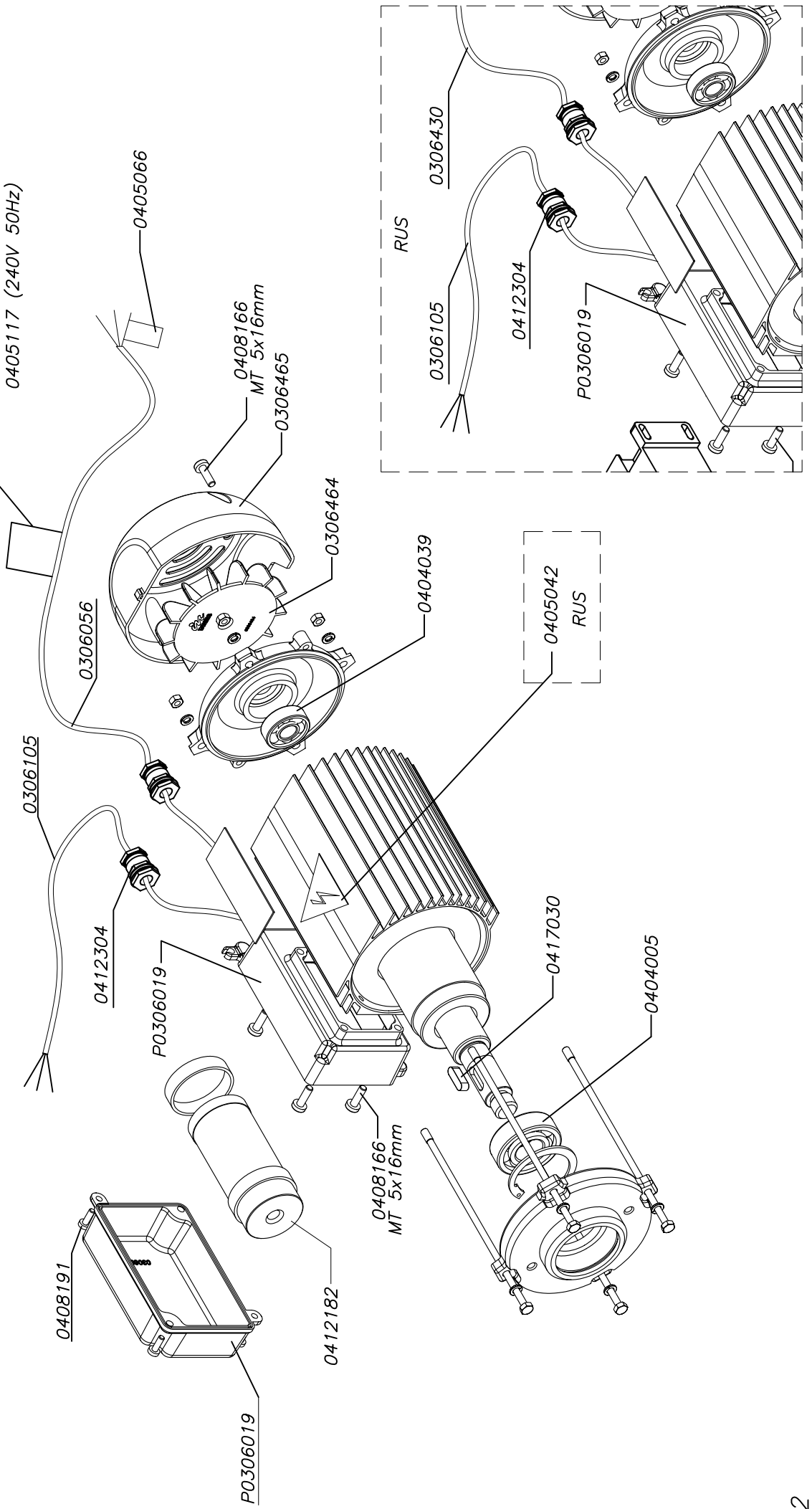

IM-30 MM SAP: 147
IM-30 MM RUS SAP: 153

Motor Three Phase (0413054 60Hz)
(0413056 50Hz)

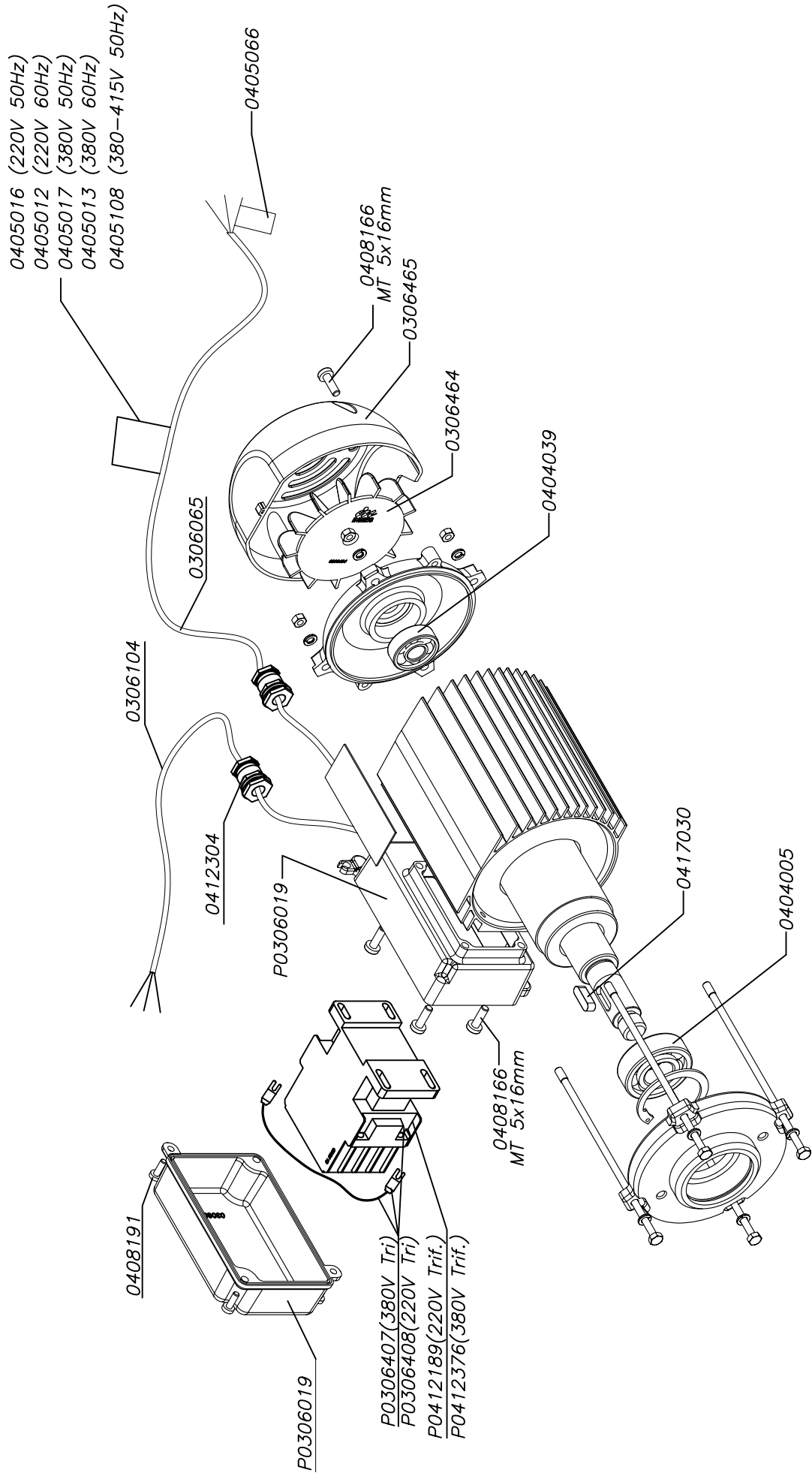

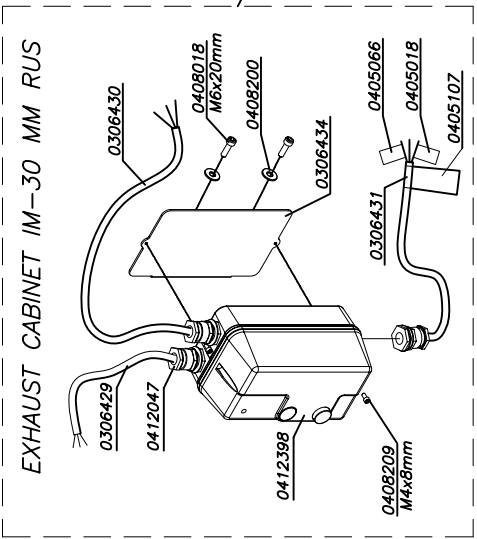
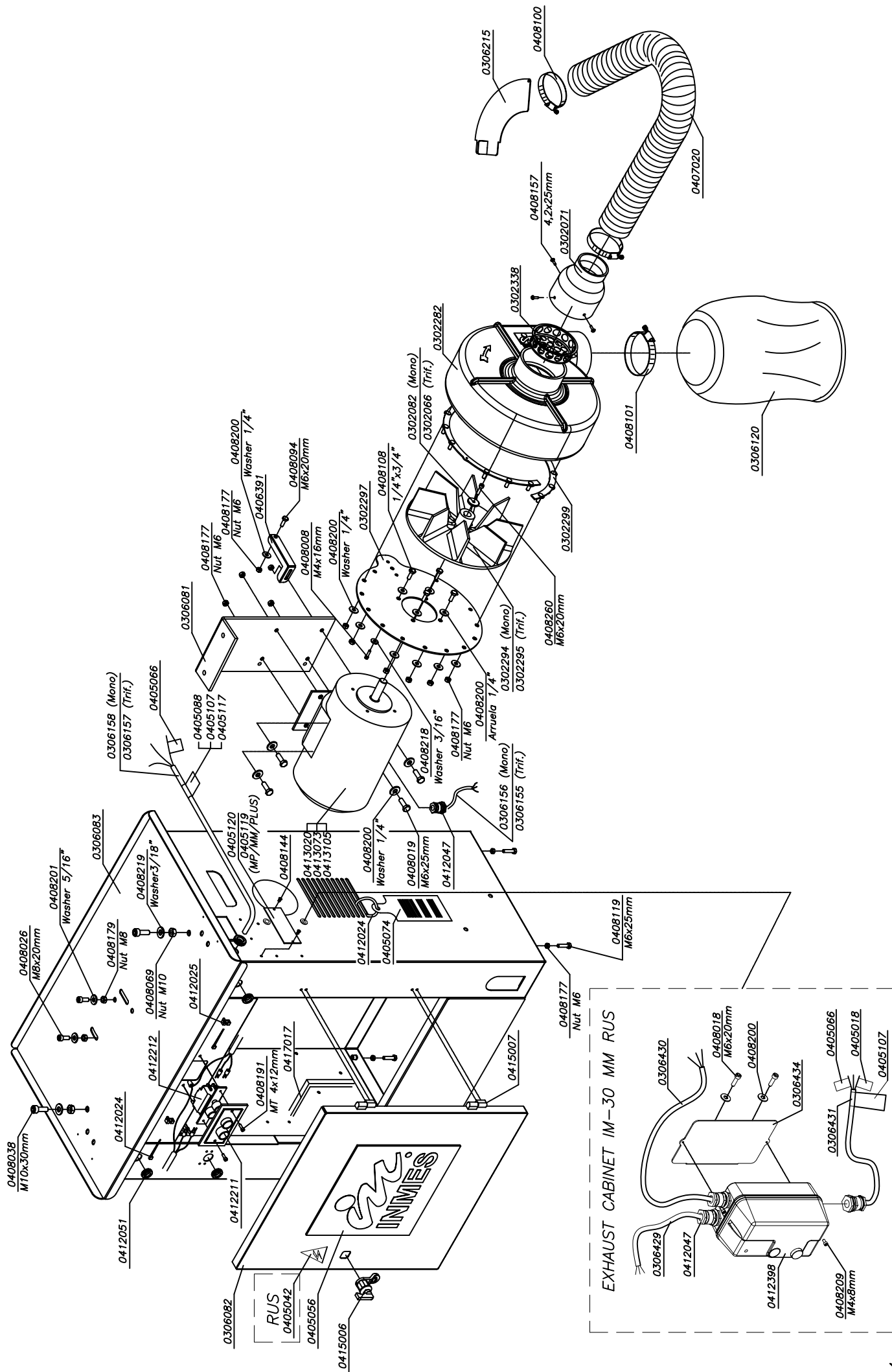

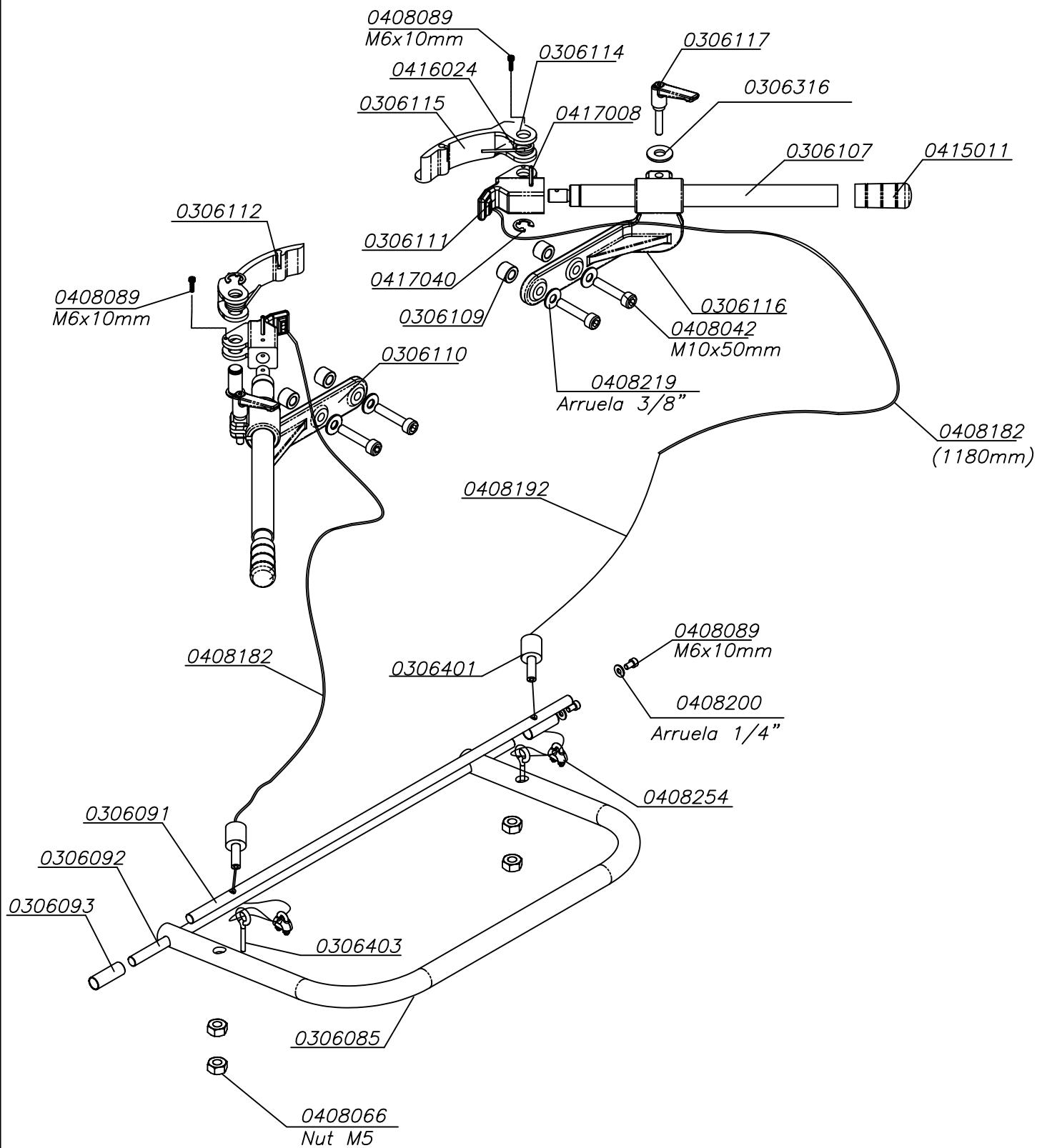



INMES

Rod. SC 438 - Km 184
Caixa Postal 65 - CEP 88750-000
Braço do Norte - SC - Brasil
<http://www.inmes.com.br>
e-mail: vendas@inmes.com.br
SAC 0300 788 2022
+55 (48) 3658 3702